

# NEWPORT CENTER SUBLEASE OPPORTUNITY

## 23 CORPORATE PLAZA • NEWPORT BEACH • CA

**Available Space:** Suite 280

**Size:** 7,396 RSF

**Rental Rate:** \$3.50 / Full Service Gross

**Term:** Through 10/31/2010

**Availability:** Upon 60 Days Notice



### Features:

- > Furniture potentially available
- > Excellent location – across the street from Bristol Farms & Gulf Stream
- > Free parking (4:1000)
- > Call to show

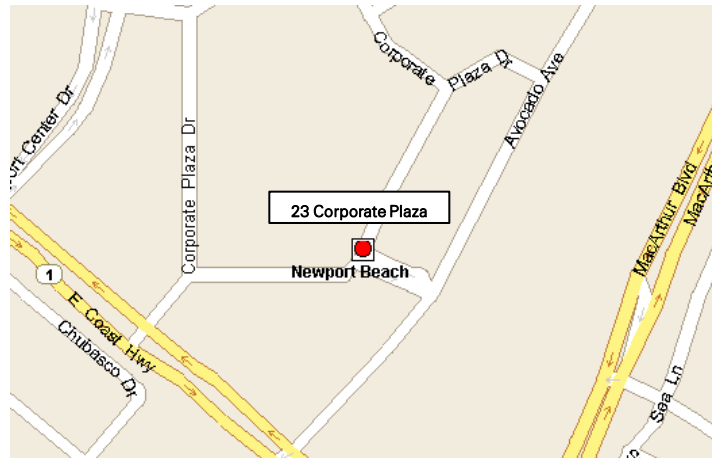

### TRAVERS REALTY

840 Newport Center Drive, Suite 770

Newport Beach, California 92660

Tel. (949) 644-5900 | Fax. (949) 644-5990

CA Lic # - 00478795 | OC Lic # - 01202640

Come visit our website at [www.traversrealty.com](http://www.traversrealty.com)

### For More Information:

Steven T. Card – Senior Vice President /  
Managing Director  
CA DRE License #: 01204748  
[scard@traversrealty.com](mailto:scard@traversrealty.com)

Michael T. Beattie – Associate  
CA DRE License #: 01742584  
[mbeattie@traversrealty.com](mailto:mbeattie@traversrealty.com)

This information has been obtained from sources believed reliable. While we do not doubt its accuracy, we have not verified it and make no guarantee, warranty or representation about it. It is your responsibility to independently confirm its accuracy and completeness. Any projections, opinions, assumptions or estimates used are for example only and do not represent the current or future performance of the property. The value of this transaction to you depends on tax and other factors which should be evaluated by your tax, financial and legal advisors. You and your advisors should conduct a careful, independent investigation of the property to determine to your satisfaction the suitability of the property for your needs.

TRAVERS REALTY

Floor Plan – 23 Corporate Plaza, Suite 280, Newport Beach, CA

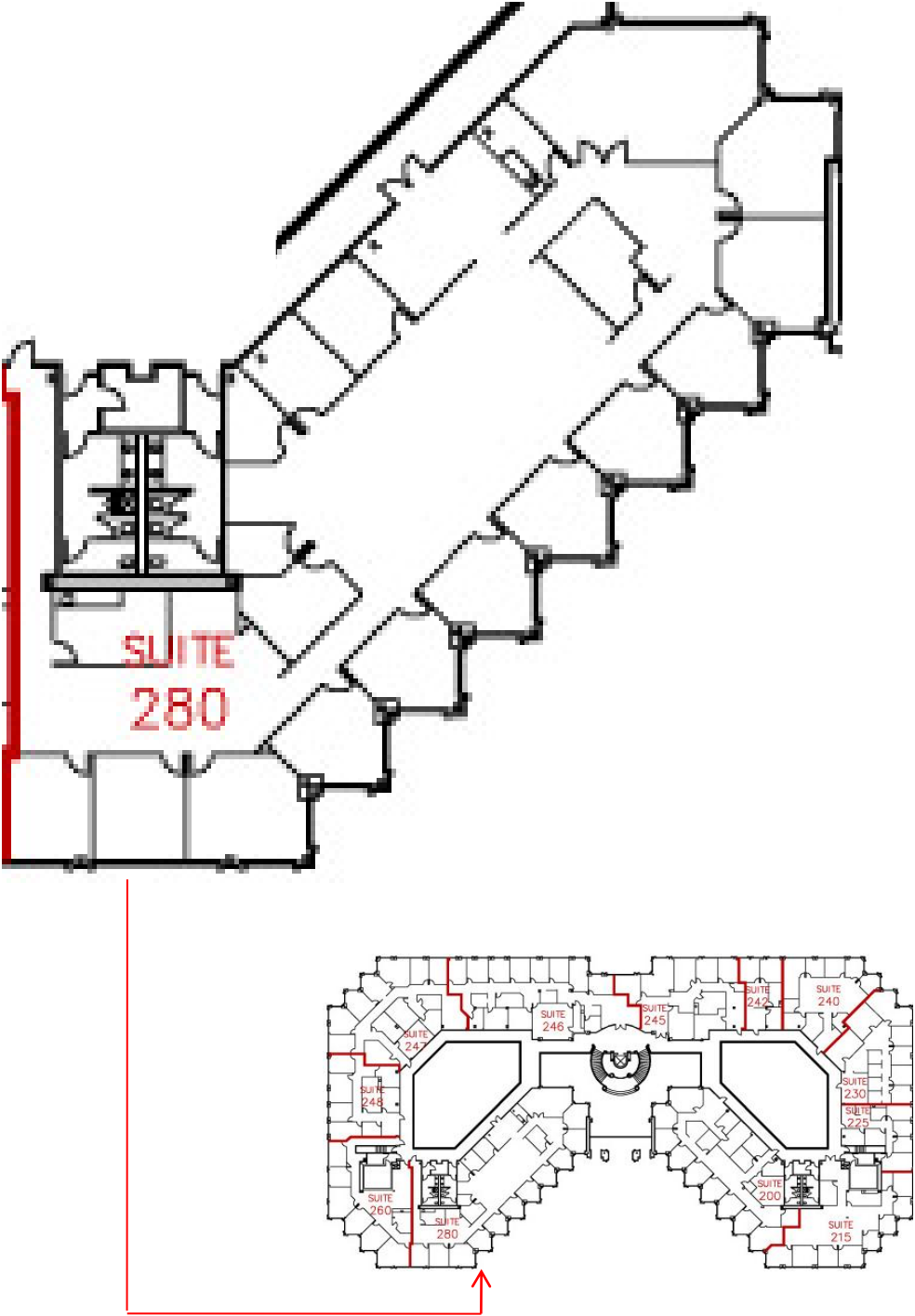

This information has been obtained from sources believed reliable. While we do not doubt its accuracy, we have not verified it and make no guarantee, warranty or representation about it. It is your responsibility to independently confirm its accuracy and completeness. Any projections, opinions, assumptions or estimates used are for example only and do not represent the current or future performance of the property. The value of this transaction to you depends on tax and other factors which should be evaluated by your tax, financial and legal advisors. You and your advisors should conduct a careful, independent investigation of the property to determine to your satisfaction the suitability of the property for your needs.